

PAGE-256

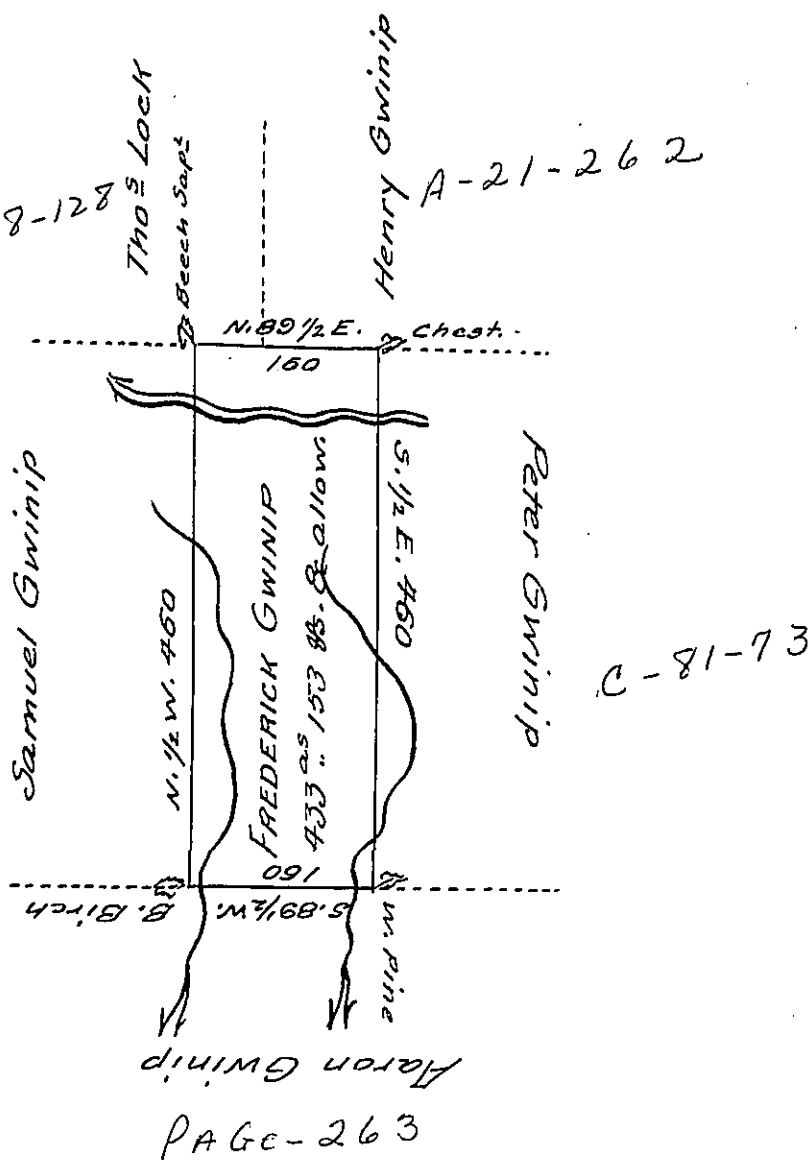

PAGE-263

A Draft of a tract of land called — situate in the County of Luzerne, adjoining Henry Gwinip & others, surveyed the 6th day of September 1792 for Frederick Gwinip in pursuance of a warrant bearing date the 3^d day of April 1792 Containing Four hundred thirty — three acres & one hundred & Fifty three perch^s. & the allowance of Six $\frac{1}{2}$ Cent &c.

Anty Crothers, D.S.

To Dan^l Brodhead, Esq^r
Surveyor General.

IN TESTIMONY that the above is a copy of the original remaining on file in the Department of Internal Affairs of Pennsylvania, made conformably to an Act of Assembly approved the 16th day of February, 1833, I have hereunto set my Hand and caused the Seal of said Department to be affixed at Harrisburg, this ninth day of January 1905.

James P. Brown
Secretary of Internal Affairs.